

# Spare parts HKS 62HD

# Cable Cutter

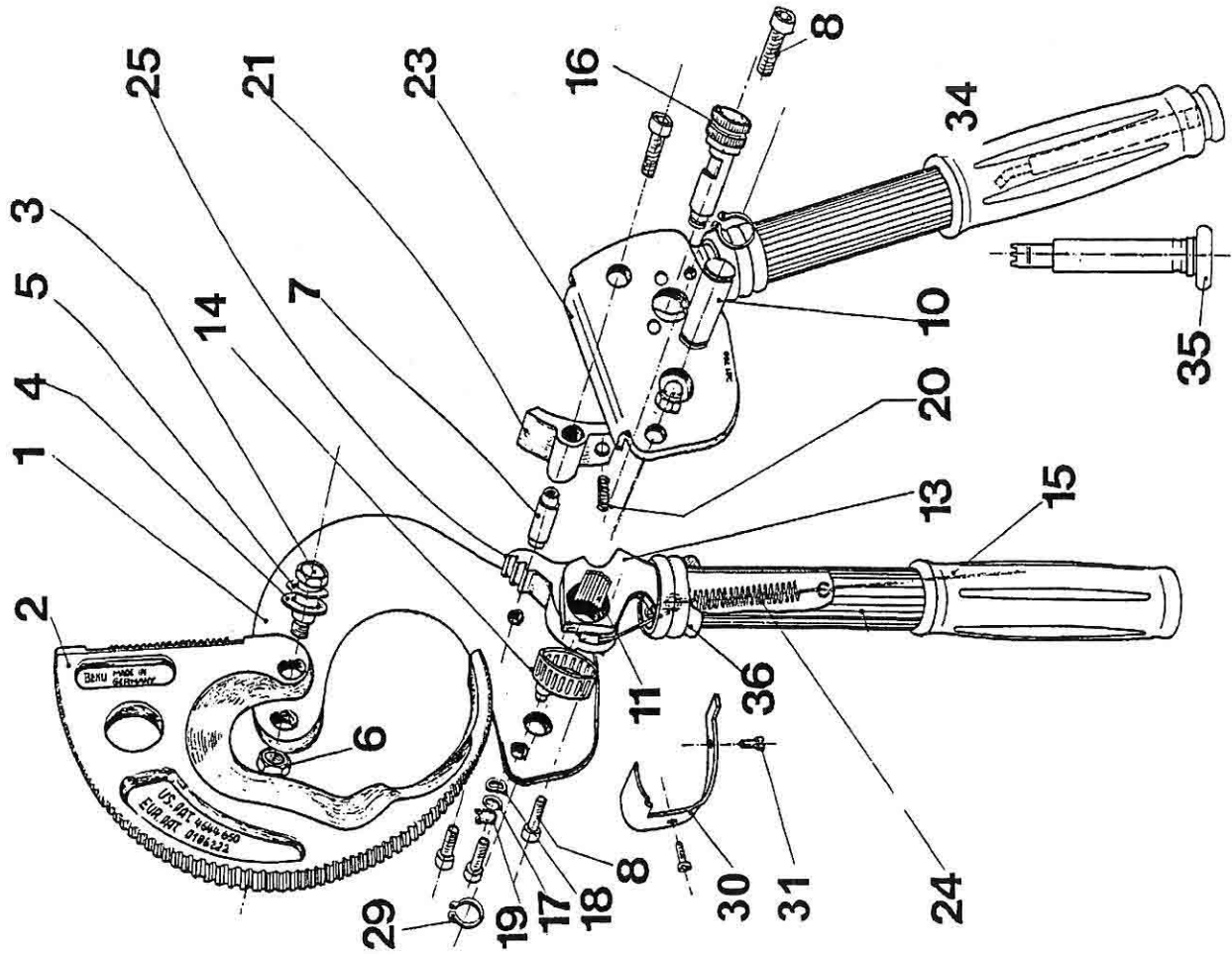

| Part No. | Each per cutter | Description  |
|----------|-----------------|--|
| 1        | 1               | Fixed blade  |
| 2        | 1               | Moveable blade   |
| 3        | 1               | Pinscrew   |
| 4        | 1               | Plate spring   |
| 5        | 1               | Adjustment washer  |
| 6        | 1               | Headed nut   |
| 7        | 2               | Distance case  |
| 8        | 6               | Assembling screw   |
| 10       | 1               | Axle   |
| 11       | 21              | Bearing needles 2 mmØx21,8 lg.                             |
| 12       | 1               | discontinued - see below!                                  |
| 13       | 1               | Eccentric lever, c/w cover tube (pls. quote colour)        |
| 14       | 1               | Bearing cage for ratchet 25x29x17                          |
| 15       | 1               | Grip   |
| 16       | 1               | Locking axle   |
| 17       | 1               | Washer   |
| 18       | 1               | Plate spring   |
| 19       | 1               | Circlip  |
| 20       | 1               | Spring   |
| 21       | 1               | Holding ratchet  |
| 23       | 1               | Cover plate, c/w handle tube and cover (pls. quote colour) |
| 24       | 1               | Tension spring, c/w wire bows                              |
| 25       | 1               | Advance ratchet with 29 mm boring                          |
| 29       | 2               | Circlip for part 10  |
| 30       | 1               | Cover plate  |
| 31       | 2               | Screw for cover plate                                      |
| 34       | 1               | Grip with holder for cleaning comb                         |
| 35       | 1               | Cleaning comb  |
| 36       | 2               | Rubber ring  |

| Assembling Sets |   |
|-----------------|---|
| 32              | 1<br>Eccentric lever (13), complete with ratchet (25), Spring (24), Bearing needles (11) and Needle cage (14) |
| 33              | 1<br>Moveable blade, complete with Pinscrew (3), Plate washer (4), Adjustment washer (5) and Nut (6)          |